

IlSCO® Copper Split Bolts

ORDER ONLINE

Features

- Manufactured from high strength copper alloy for maximum conductivity and high breakage resistance
- Precision tooled threads allow use of maximum torque
- UL Listed and CSA Certified, rated 600 volts
- For copper conductor only

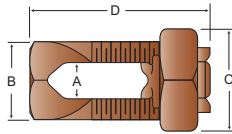

Split Bolts

| Part Number | Wire Range – Equal Main & Tap | | Min Tap with One Max Main | Dimensions | | | |
|-------------|-------------------------------|----------|---------------------------|------------|------|------|---------|
| | Minimum | Maximum | | A | B | C | D (max) |
| IK-10 | 12 Str. | 10 Str. | 16 Str. | .15 | .38 | .50 | .85 |
| IK-8 | 16 Str. | 8 Str. | 16 Str. | .15 | .38 | .50 | .85 |
| IK-6 | 10 Sol. | 6 Sol. | 16 Sol. | .17 | .50 | .63 | 1.05 |
| IK-4 | 8 Sol. | 4 Sol. | 16 Sol. | .22 | .56 | .69 | 1.05 |
| IK-3 | 6 Sol. | 2 Sol. | 12 Sol. | .33 | .69 | .82 | 1.32 |
| IK-2 | 6 Sol. | 2 Str. | 14 Str. | .33 | .69 | .82 | 1.32 |
| IK-1/0 | 4 Sol. | 1/0 Str. | 14 Sol. | .38 | .75 | .88 | 1.64 |
| IK-2/0 | 2 Sol. | 2/0 Str. | 14 Str. | .42 | .82 | 1.00 | 1.82 |
| IK-3/0 | 2 Sol. | 3/0 Str. | 12 Sol. | .47 | .88 | 1.13 | 2.00 |
| IK-250 | 1/0 Sol. | 250 MCM | 10 Sol. | .58 | 1.00 | 1.31 | 2.08 |
| IK-350 | 4/0 Str. | 350 MCM | 8 Sol. | .75 | 1.50 | 1.63 | 2.63 |

IlSCO® Tin Plated Copper Split Bolts

ORDER ONLINE

Features

- Manufactured from high strength copper alloy for maximum conductivity and high breakage resistance
- Precision tooled threads allow use of maximum torque
- Electroplated with tin for low contact resistance
- Serrated spacer bar makes a secure connection
- UL 486A Listed, rated for 600 volts

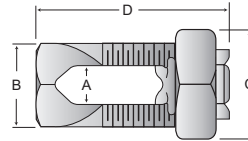

Tin Plated Split Bolts

| Part Number | Wire Range | | Tap Copper and Aluminum | ACSR-AAAC 5005 | A | B | C | D |
|-------------|--|-----------------------|--|-----------------------|------|-------|-------|---------|
| | Main Copper and Aluminum | ACSR-AAAC 5005 | | | | | | |
| SK-6 | 8 Str. – 14 Str. | 8 (6 – 1) | 8 Str. – 14 Str. | 8 (6 – 1) | .166 | 1/2 | 5/8 | 1 7/64 |
| SK-4 | 6 Str. – 10 Str. | 6 (6 – 1) | 6 Str. – 10 Str. | 6 (6 – 1) | .217 | 9/16 | 11/16 | 1 17/64 |
| SK-3 | 4 Str. – 8 Sol./Str. AL 2 Sol. – 8 Sol./Str. CU | 6 (6 – 1) – 4 (7 – 1) | 4 Str. – 8 Sol./Str. AL 2 Sol. – 8 Sol./Str. CU | 6 (6 – 1) – 4 (7 – 1) | .326 | 11/16 | 13/16 | 1 35/64 |
| SK-2 | 2 Str. – 8 Sol./Str. | 3 (6 – 1) – 2 (6 – 1) | 2 Str. – 8 Sol./Str. | 6 (6 – 1) – 2 (7 – 1) | .326 | 11/16 | 13/16 | 1 35/64 |

| Part Number | Wire Range | | Aluminum Range (NOT UL LISTED) | | A | Dimensions | | |
|-------------|-------------------------|-------------------------|--------------------------------|-------------------------|------|------------|---------|---------|
| | Main Copper | Tap Copper | Main | Tap | | B | C | D |
| SK-1/0 | 1/0 Str. – 6 Sol./Str. | 1/0 Str. – 10 Sol./Str. | 3 (6 – 1) – 1 (6 – 1) | 6 (6 – 1) – 1 (6 – 1) | .376 | 3/4 | 7/8 | 1 41/64 |
| SK-2/0 | 2/0 Str. – 10 Sol./Str. | 2/0 Str. – 10 Sol./Str. | 1 (6 – 1) – 1/0 (6 – 1) | 6 (6 – 1) – 1/0 (6 – 1) | .420 | 13/16 | 1 | 1 53/64 |
| SK-3/0 | 3/0 Str. – 6 Sol./Str. | 3/0 Str. – 6 Sol./Str. | 1 (6 – 1) – 2/0 (6 – 1) | 8 (6 – 1) – 2/0 (6 – 1) | .466 | 7/8 | 1 1/8 | 2 |
| SK-250 | 250 MCM – 4 Sol./Str. | 250 MCM – 4 Sol./Str. | 2/0 (6 – 1) – 4/0 (6 – 1) | 4 (7 – 1) – 4/0 (6 – 1) | .577 | 1 | 1 15/16 | 2 21/64 |
| SK-350 | 350 MCM – 1 Str./Str. | 350 MCM – 1 Str./Str. | 3/0 (6 – 1) – 4/0 (6 – 1) | 4 (6 – 1) – 4/0 (6 – 1) | .746 | 1 1/2 | 1 5/8 | 2 5/8 |